

## Modulöversikt – Kurvor

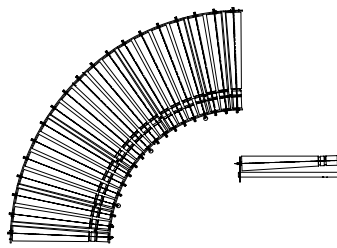

AX100 – Kurva, driven 90°  
Typ DKA \*



AX100 – Kurva, driven 90° med  
driverolls

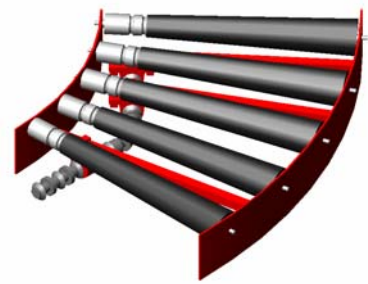

AX100 – Kurva, driven 45°  
Typ DKA \*

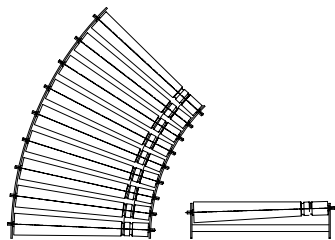

AX100 – Kurva, driven 45° med  
driverolls

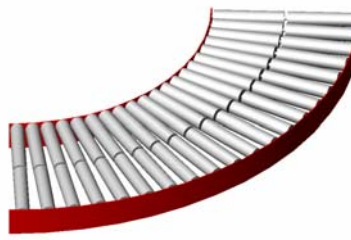

AX100 – Kurva, odreven med  
delade rullar 90° \*

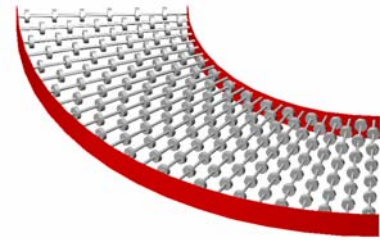

AX100 – Kurva, odreven hjulkurva  
90° Typ HJK \*

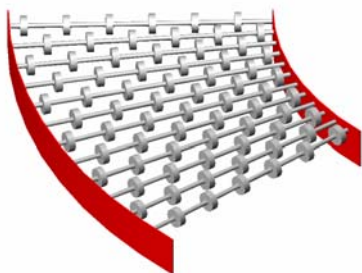

AX100 – Kurva, odreven hjulkurva  
45° Typ HJK \*

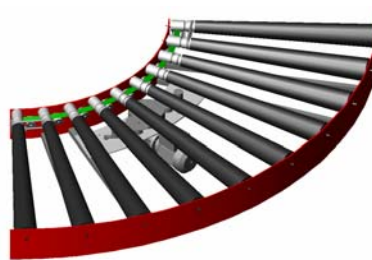

FR100 – Kurva, driven 90°  
Typ DKA \*

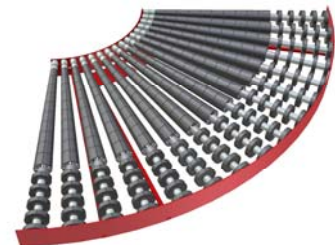

FR100 – Kurva, driven 90°. Stor  
rullängd

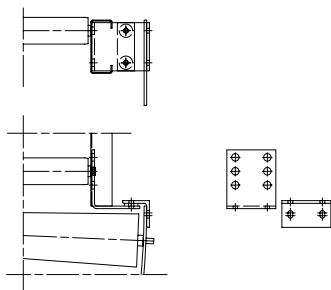

FR 100 – Skarv mellan rak bana  
och en kurva med längre rullar

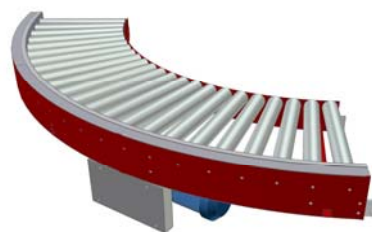

KE100 – Kurva, driven 90°

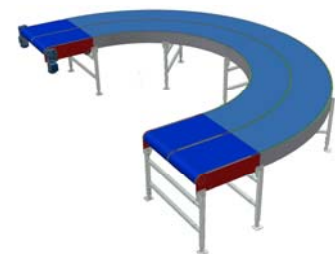

PL100 – Dubbla  
plastlamelltransportörer, kurvor  
med olika hastigheter

\* Datablad finns

## Modulöversikt - Kurvor

|  |  |  |
|--|--|--|
|  <p>PL100 – Plastlamelltransportör,<br/>kurva</p> |  |  |
|  |  |  |
|  |  |  |
|  |  |  |

\* Datablad finns